

## **Appendix 1 - Merton Cabinet 21<sup>st</sup> March 2022**

### **Plans of the Order land**

- Eastfields
- High Path
- Ravensbury

# MAP REFERRED TO IN THE LONDON BOROUGH OF MERTON (EASTFIELDS NO. 1) COMPULSORY PURCHASE ORDER 2022

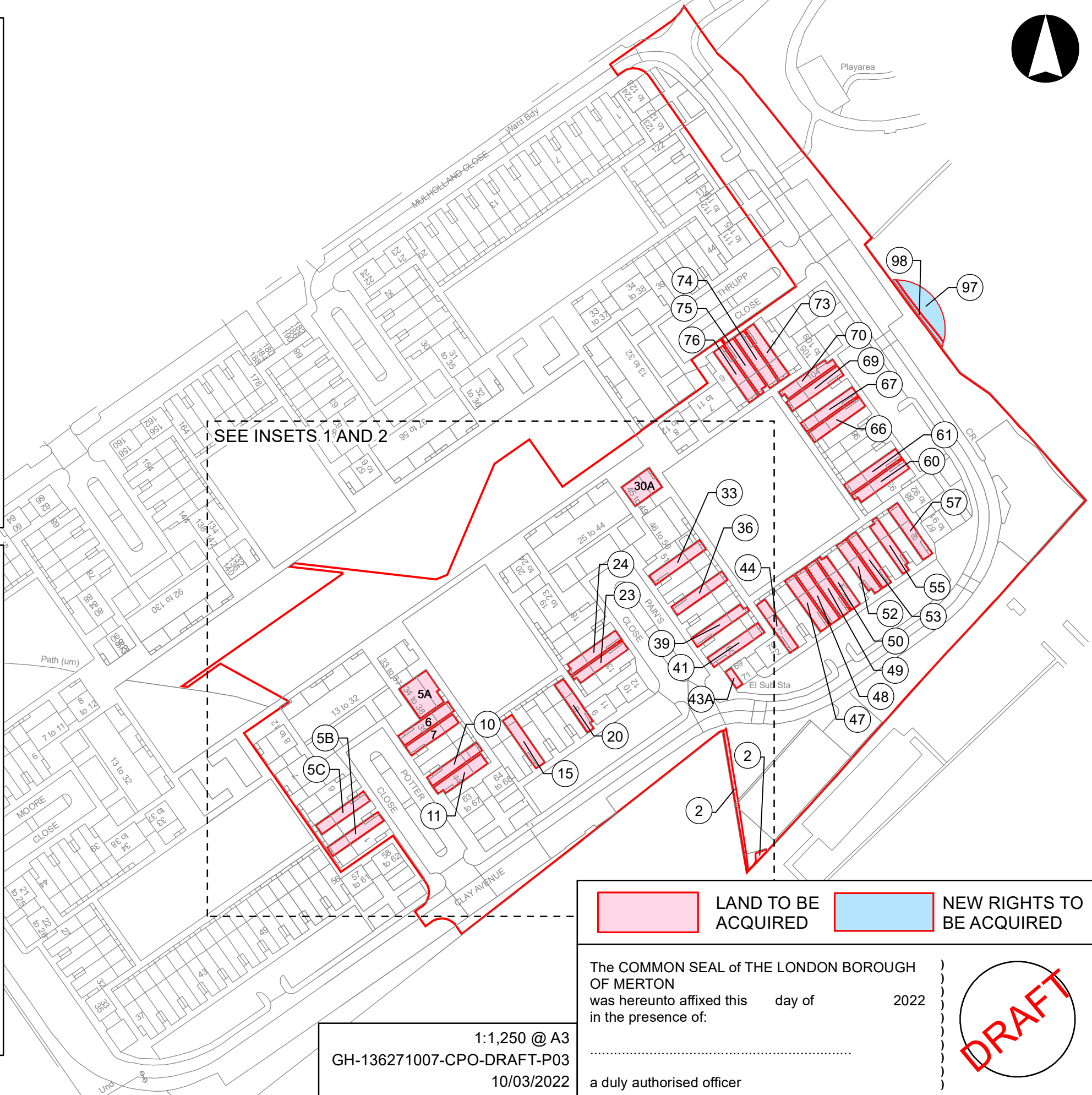
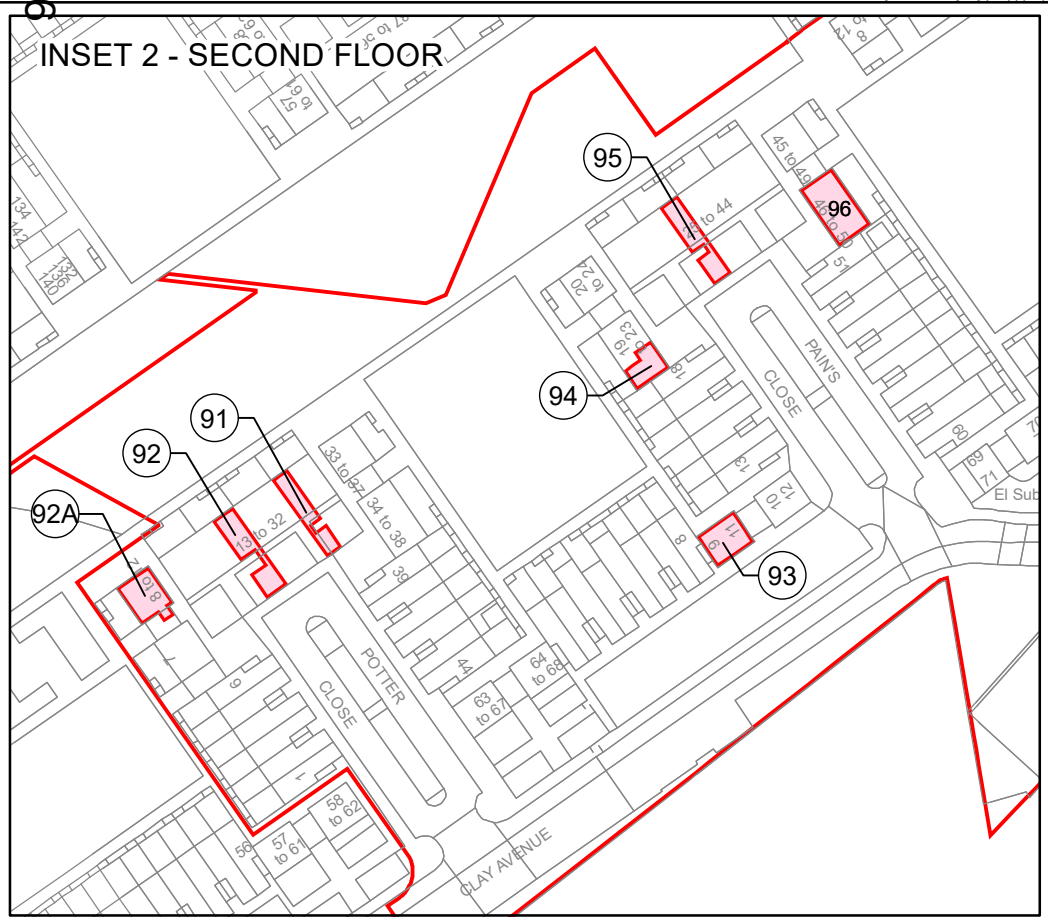
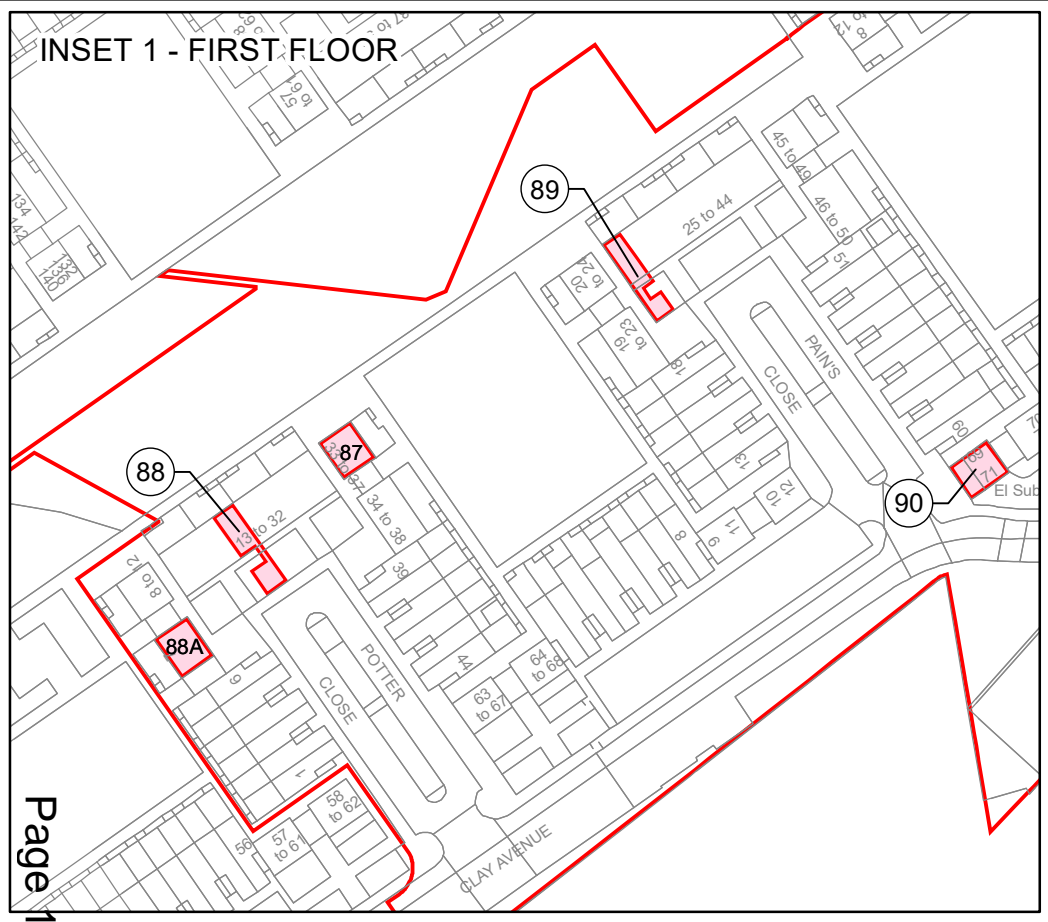

Page 106

LAND TO BE ACQUIRED
  NEW RIGHTS TO BE ACQUIRED

The COMMON SEAL of THE LONDON BOROUGH OF MERTON  
 was hereunto affixed this      day of      2022  
 in the presence of:  
 .....  
 a duly authorised officer

DRAFT

1:1,250 @ A3  
 GH-136271007-CPO-DRAFT-P03  
 10/03/2022



# MAP REFERRED TO IN THE LONDON BOROUGH OF MERTON (HIGH PATH NO.1) COMPULSORY PURCHASE ORDER 2022

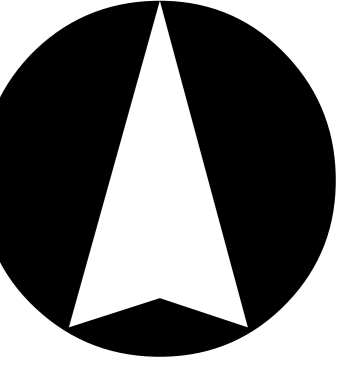

Page 107

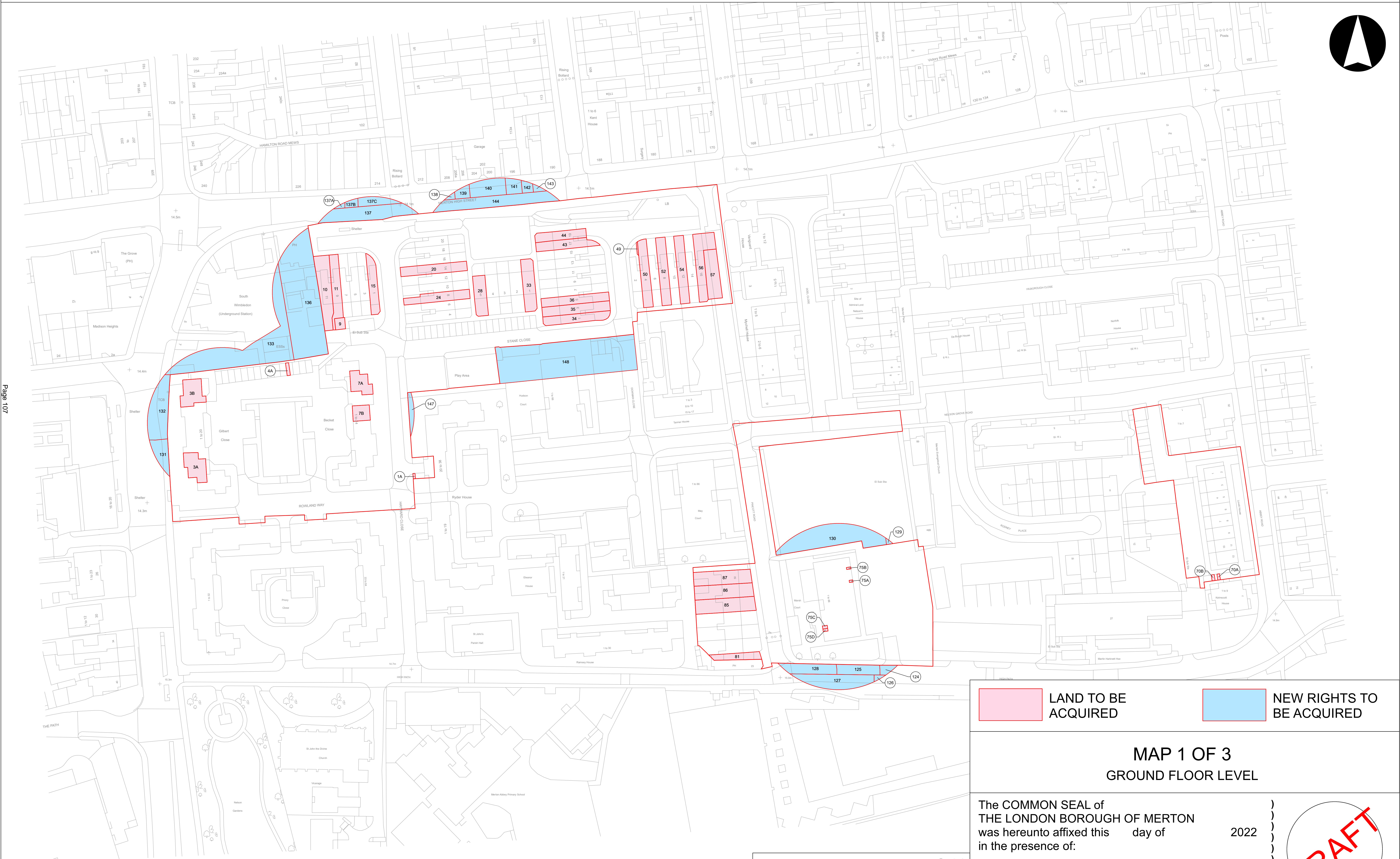

	LAND TO BE ACQUIRED		NEW RIGHTS TO BE ACQUIRED
---	---------------------	---	---------------------------

## MAP 1 OF 3 GROUND FLOOR LEVEL

The COMMON SEAL of  
THE LONDON BOROUGH OF MERTON  
was hereunto affixed this      day of      2022  
in the presence of:

.....  
a duly authorised officer



1:500 @ A0  
GH-136271010-CPO-1-DRAFT-P08  
10/03/2022



# MAP REFERRED TO IN THE LONDON BOROUGH OF MERTON (HIGH PATH NO.1) COMPULSORY PURCHASE ORDER 2022

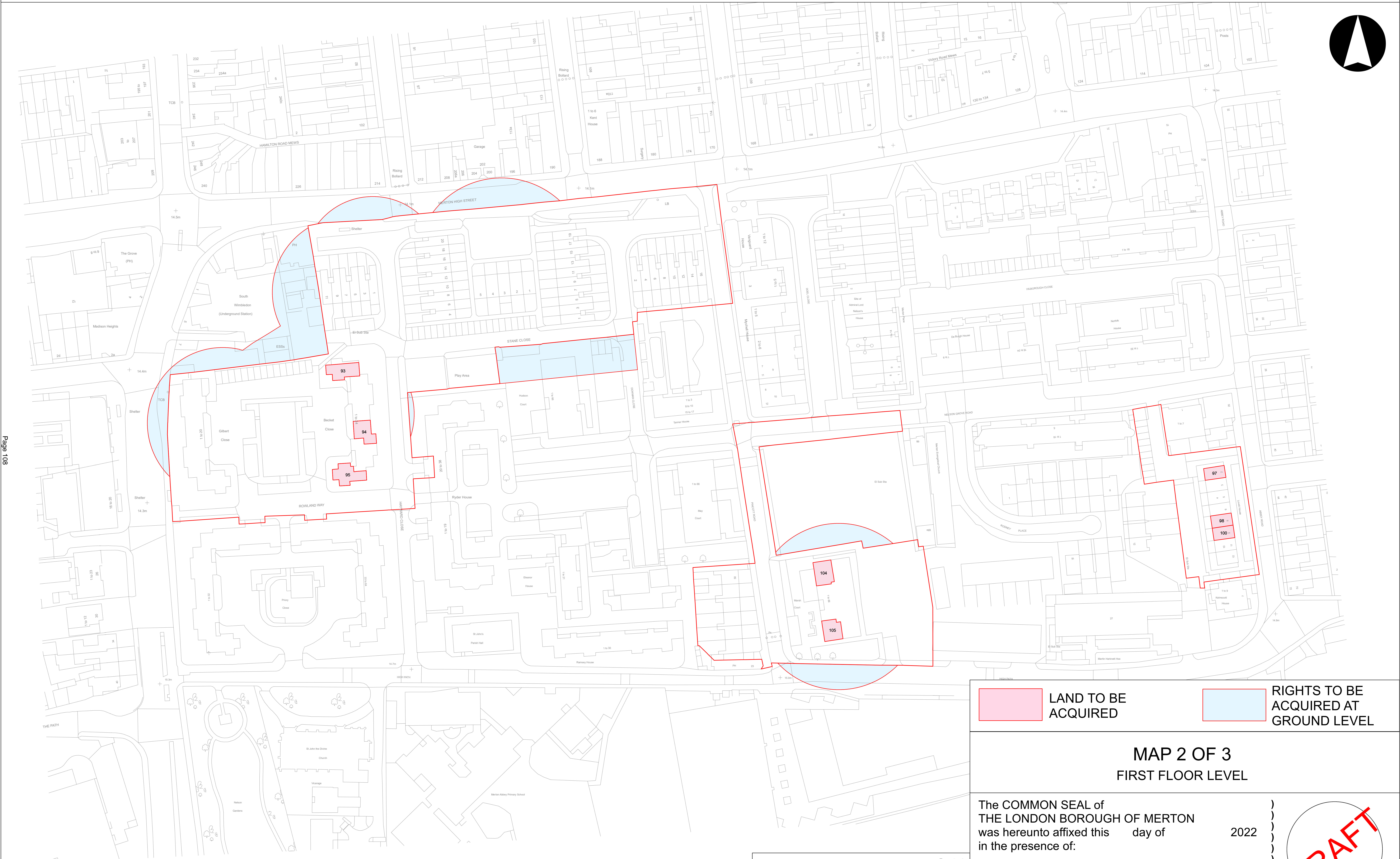
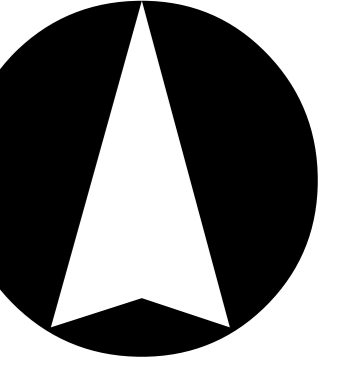

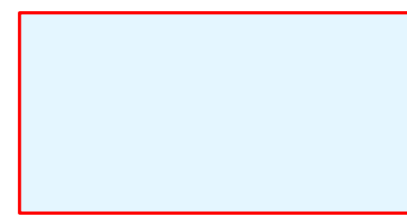
	LAND TO BE ACQUIRED		RIGHTS TO BE ACQUIRED AT GROUND LEVEL
---	---------------------	---	---------------------------------------

## MAP 2 OF 3 FIRST FLOOR LEVEL

The COMMON SEAL of  
THE LONDON BOROUGH OF MERTON  
was hereunto affixed this      day of      2022  
in the presence of:

.....  
a duly authorised officer



1:500 @ A0  
GH-136271010-CPO-2-DRAFT-P07  
10/03/2022



# MAP REFERRED TO IN THE LONDON BOROUGH OF MERTON (HIGH PATH NO.1) COMPULSORY PURCHASE ORDER 2022

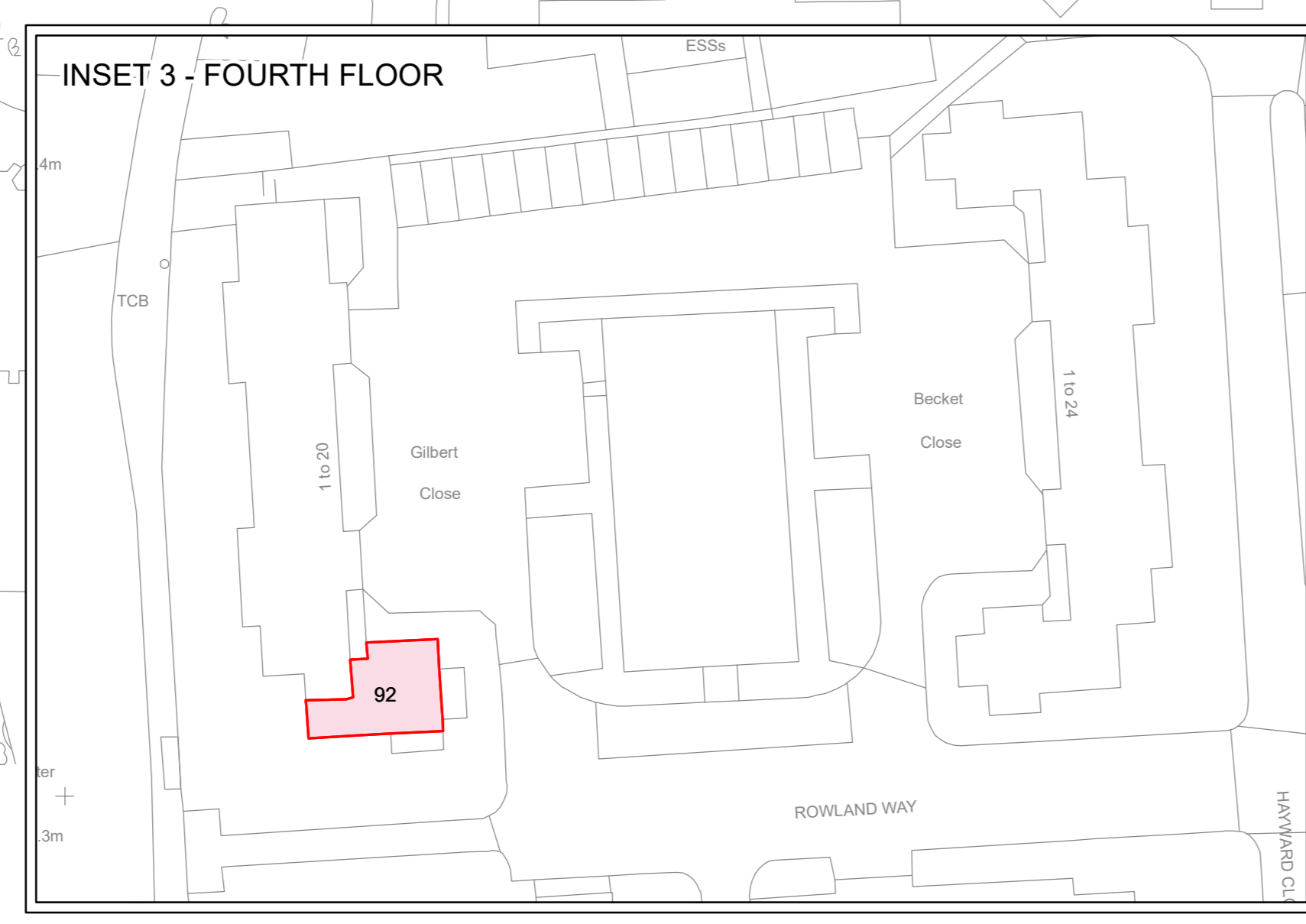
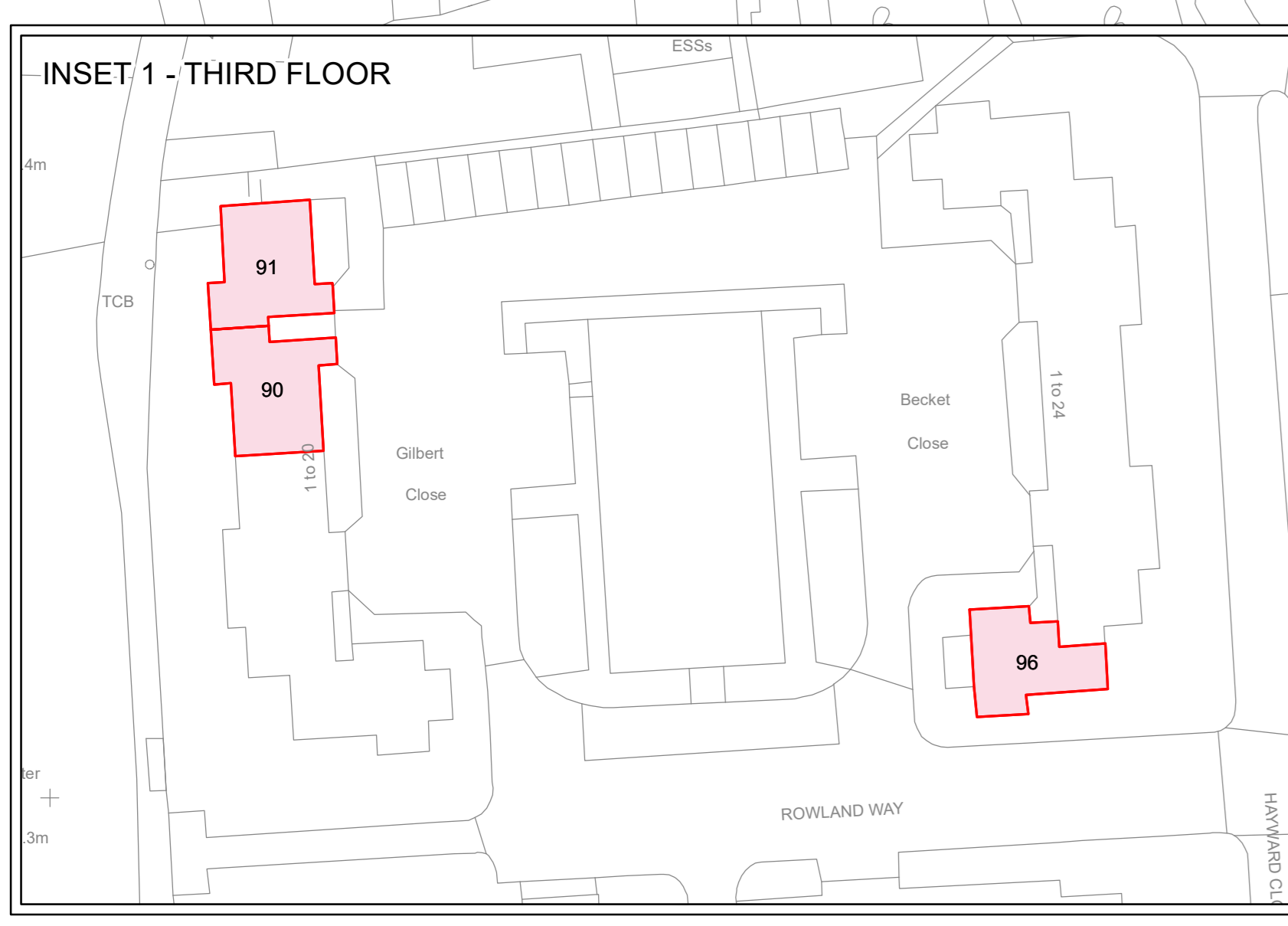
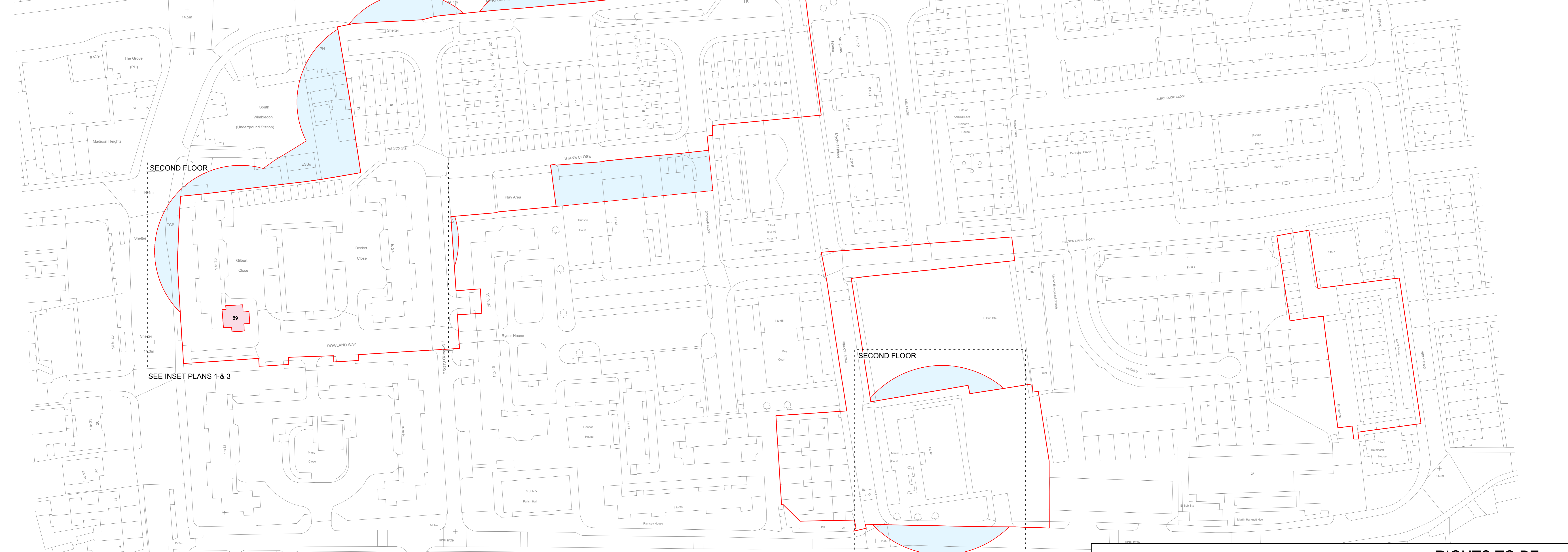
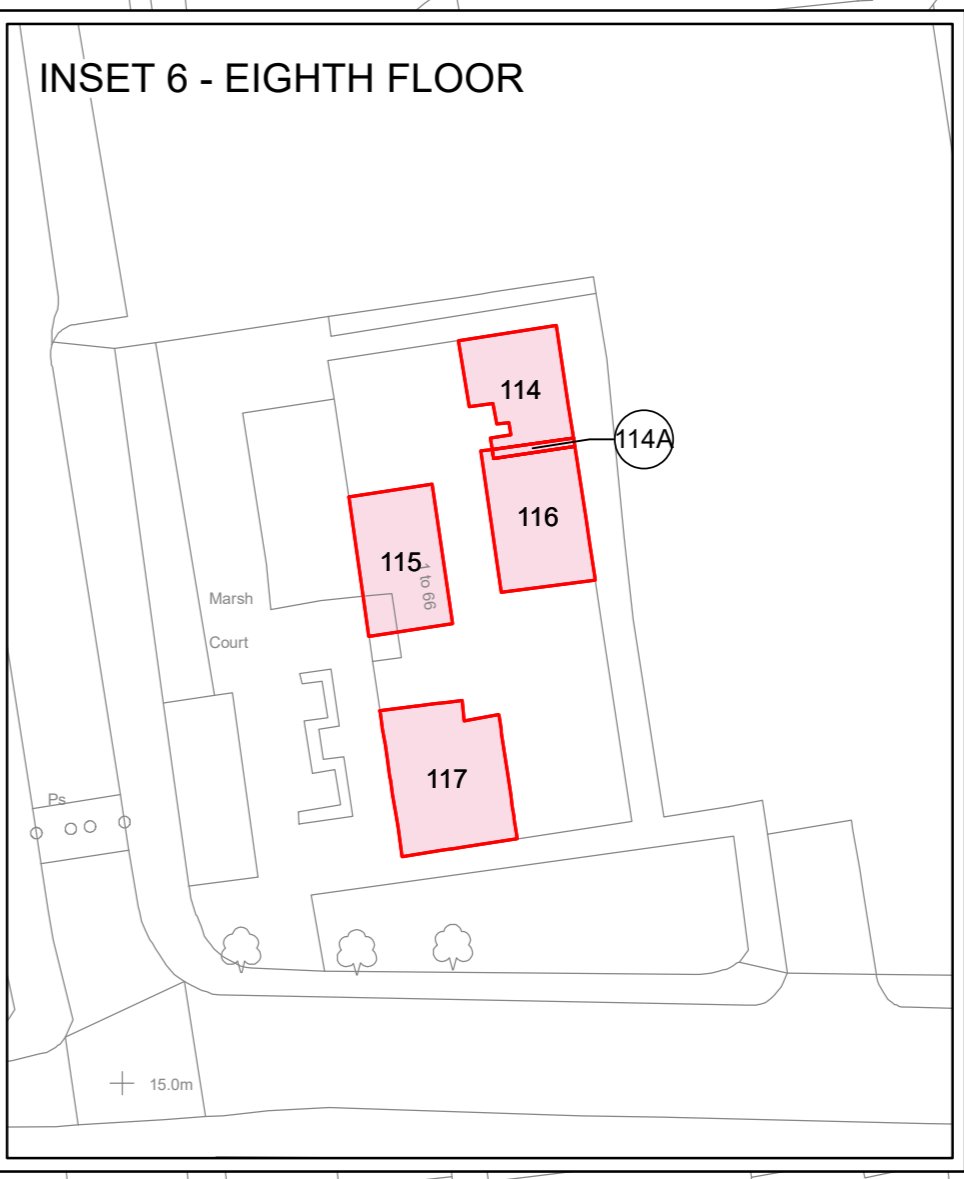
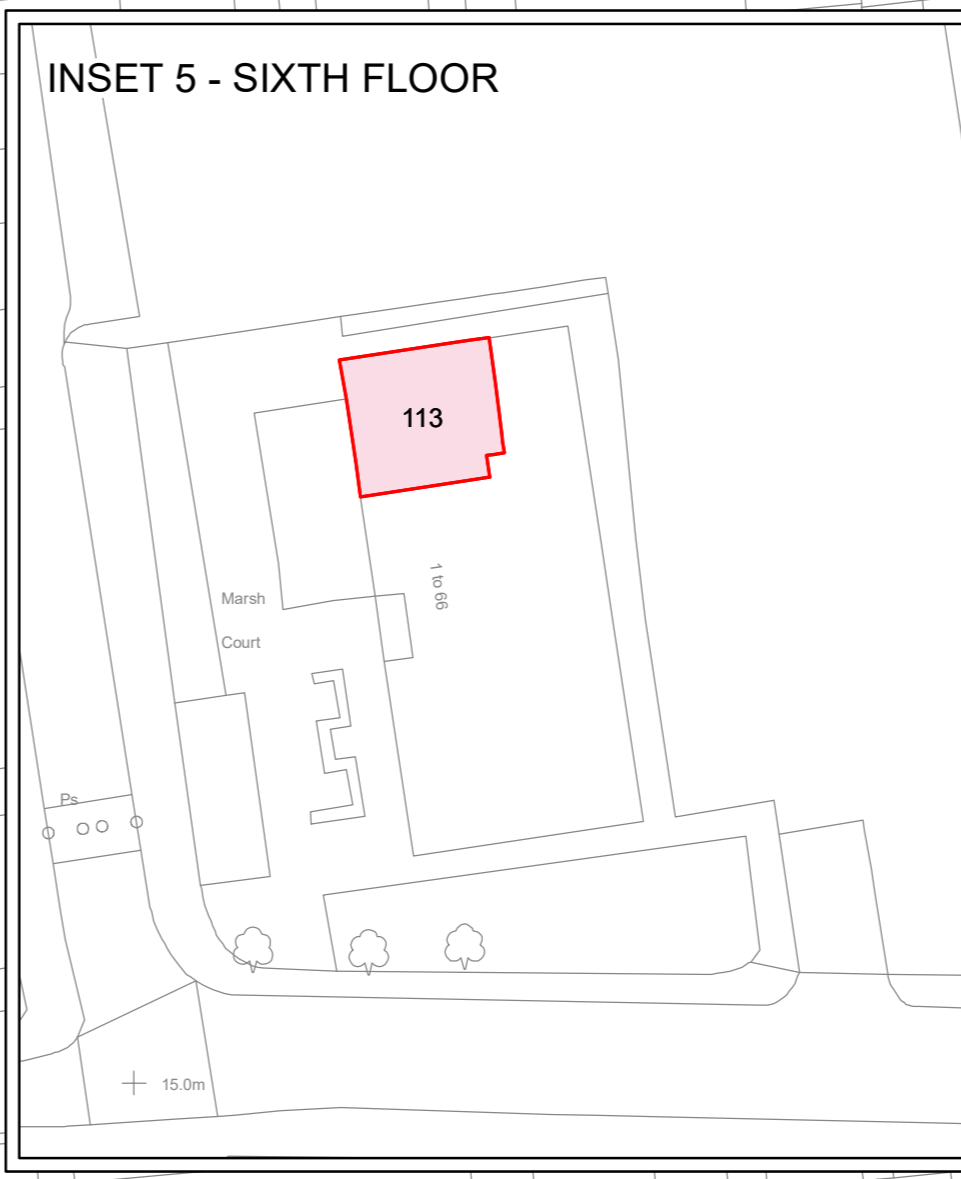
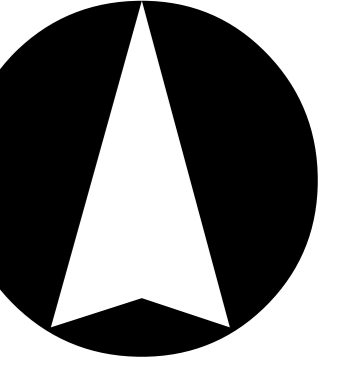

LAND TO BE ACQUIRED
  RIGHTS TO BE ACQUIRED AT GROUND LEVEL

## MAP 3 OF 3 SECOND FLOOR LEVEL AND ABOVE

The COMMON SEAL of THE LONDON BOROUGH OF MERTON was hereunto affixed this      day of      2022 in the presence of:

.....  
a duly authorised officer



1:500 @ A0  
GH-136271010-CPO-3-DRAFT-P07  
10/03/2022



**MAP REFERRED TO IN THE LONDON BOROUGH OF MERTON (RAVENSBURY No. 1)  
COMPULSORY PURCHASE ORDER**



Page 110

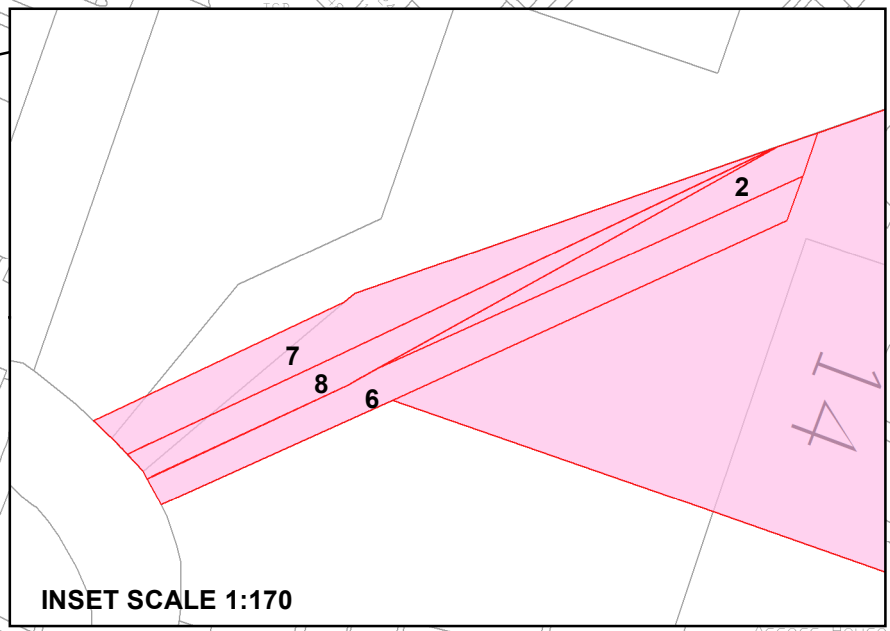
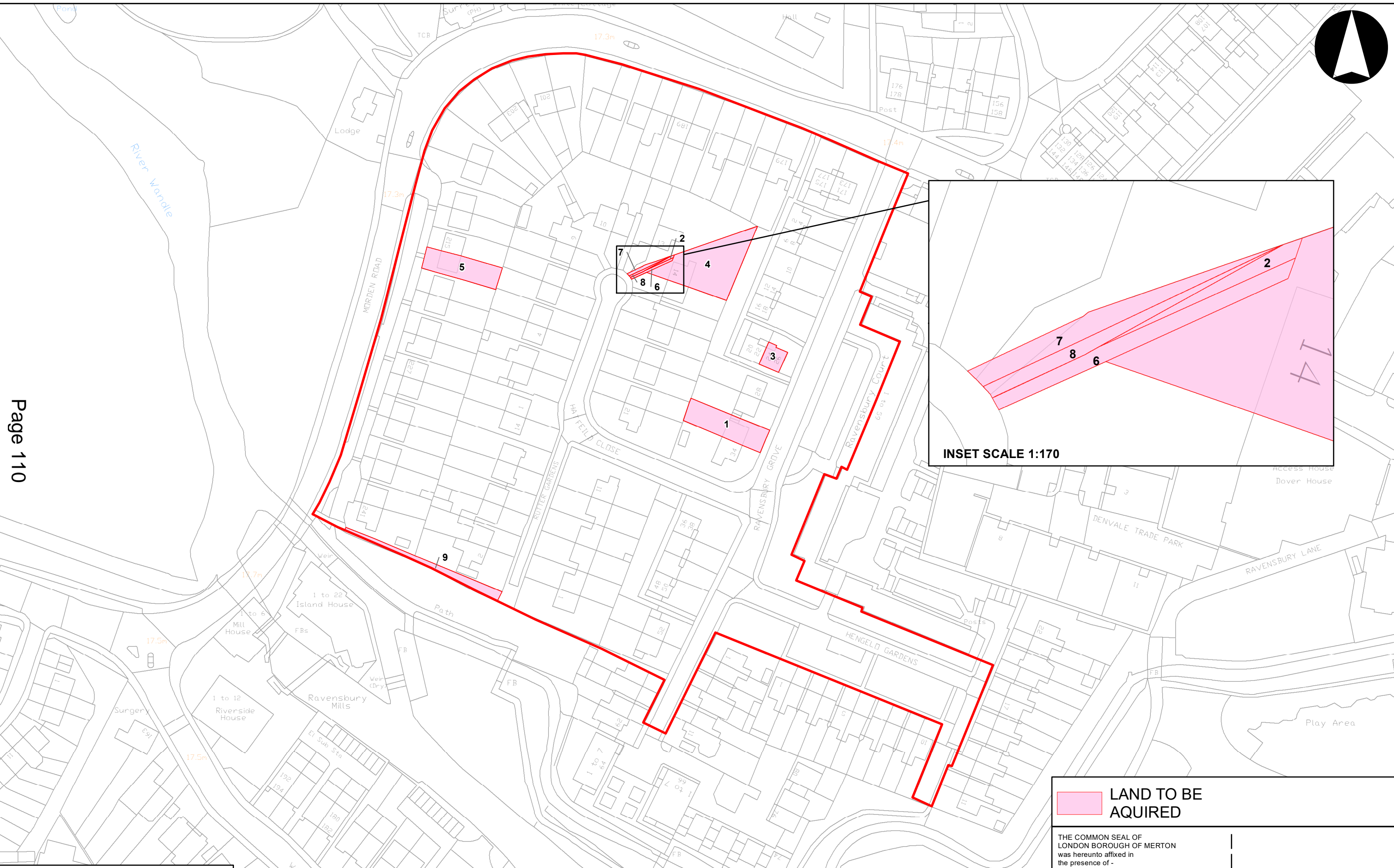

	<b>LAND TO BE AQUIRED</b>
THE COMMON SEAL OF LONDON BOROUGH OF MERTON was hereunto affixed in the presence of -	
.....	Authorised Officer
Dated.....	2022

© Crown copyright and database rights 2021 Ordnance Survey 0100031673  
 You are permitted to use this data solely to enable you to respond to, or interact with, the organisation that provided you with the data. You are not permitted to copy, sub-licence, distribute or sell any of this data to third parties in any form.

